

QUEENS HIGHWAY 31 ACRES

N.E. Coast, East End & Colliers, Cayman Islands

MLS#: 418508

CI\$2,495,000

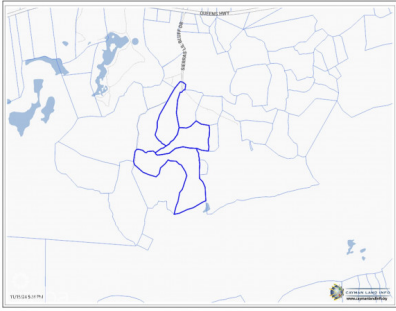

31 Acres of Development Land on Queens Highway - Your Gateway to Paradise Welcome to a rare and extraordinary opportunity on the tranquil North East Coast of the Cayman Islands. This 31-acre gem along the iconic Queens Highway offers an unparalleled canvas to create your vision of island living—be it a luxurious private estate, a boutique investment development, a subdivision or an exquisite retreat where serenity and adventure converge. A Hidden Treasure on Cayman's East Coast This expansive parcel isn't just land; it's a slice of serenity in one of the most unspoiled regions of the island. Located near must-see attractions such as the Crystal Caves and Queen Elizabeth II Botanic Park, this is nature's playground at its finest. Only a short drive away, Rum Point, Kaibo, Stingray City, and Starfish Point offer world-renowned aquatic adventures. Whether your dream is to soak in the tranquility or revel in nearby exploration, this location ensures the best of both worlds. Boundless Potential, Endless Opportunity Spanning 31 acres, this property offers limitless versatility. Dream big—envision an exclusive estate, an innovative residential development, or a one-of-a-kind vacation retreat. With land of this scale and caliber becoming increasingly scarce in Cayman, this is your chance to secure a remarkable piece of the island's future. A Sanctuary of Seclusion and Accessibility Wake each day to the sunrise dancing across the North East Coast, surrounded by lush landscapes and endless possibilities. This is more than a property—it's a lifestyle that combines peaceful seclusion with convenient access to nearby attractions and amenities. Whether it's relaxation, adventure, or a blend of both, this is the canvas on which you can craft whatever you desire. Invest in Tomorrow, Today Land of this magnitude, beauty, and potential is an investment in a legacy. Whether you're expanding your portfolio, building your dream home, or envisioning a development that transforms the way people live and experience Cayman, this property is the ultimate foundation. Your future begins here. Contact us today to discover how this 31-acre treasure on the Queens Highway can become the cornerstone of your island dream. How do you want to live your life?

Essential Information

Type Land (For Sale)	Status New	MLS 418508	Listing Type Commercial
--------------------------------	----------------------	----------------------	-----------------------------------

Key Details

Width 1383.00	Depth 2337.00	Block & Parcel 61A,35,24,26
-------------------------	-------------------------	---------------------------------------

Acreage
31.0000

Additional Fields

Block 61A	Parcel 35, 24, 26	Views Garden View	Zoning Agriculture/Residential
---------------------	-----------------------------	-----------------------------	------------------------------------------

Property Features

Road Frontage
Yes