

DEVELOPMENT LAND EAST END

East End, East End & Colliers, Cayman Islands

MLS#: 417049

CI\$400,000

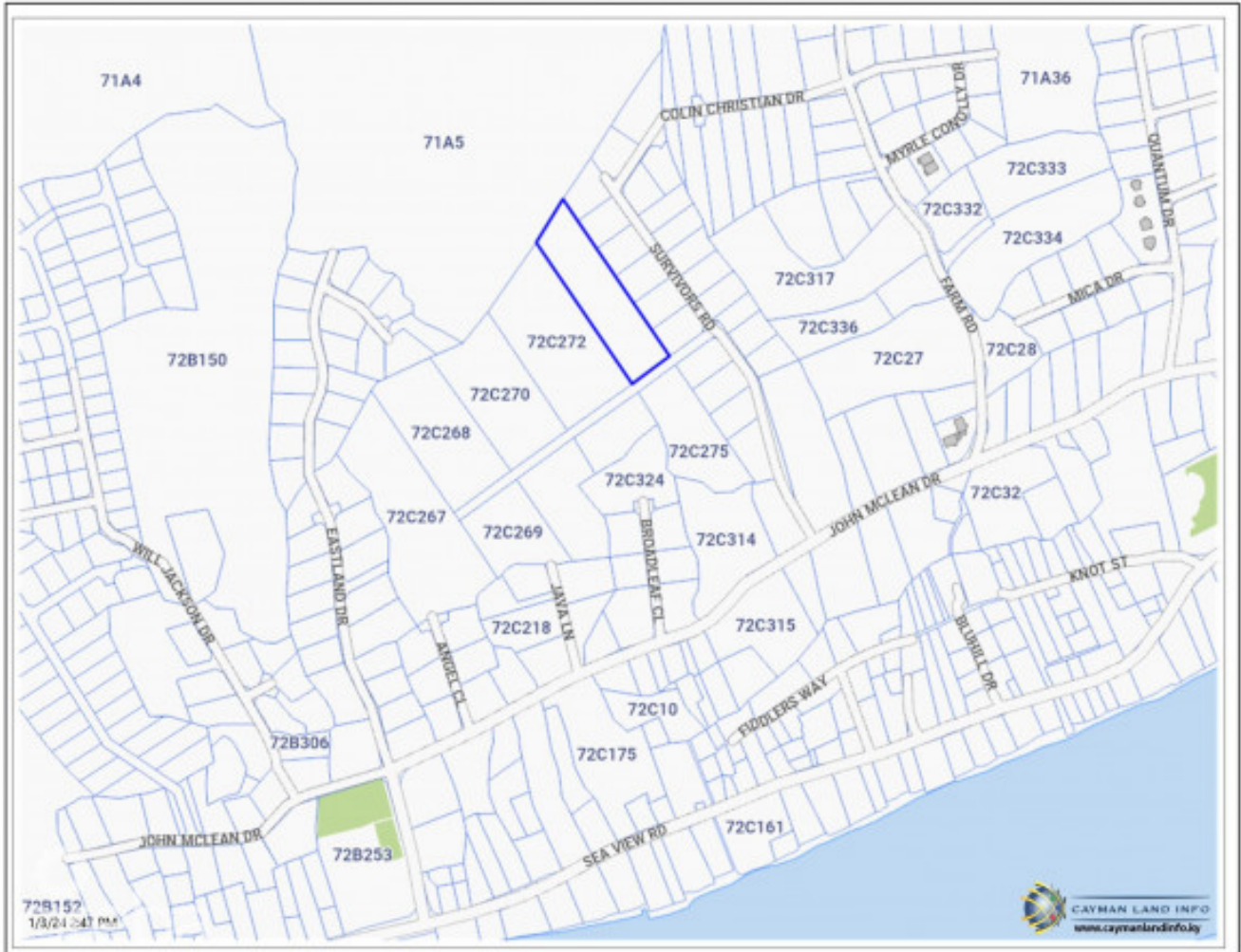

Residential developable land north of John McLean Drive generally 5ft above sea level. Suitable for subdivision into seven house lots or 36 apartments

Essential Information

Type	Status	MLS	Listing Type
Land (For Sale)	Current	417049	Residential

Key Details

Width
140.00

Depth
540.00

Block & Parcel
72C,274

Acreage
1.8100

Additional Fields

Lot Size
1.81

Views
Garden View

Zoning
**Medium Density
Residential**

Road Frontage
140

Soil
Rock