

## The Residences Mandarin Oriental Grand Cayman

Lower valley, Savannah & Bodden Town, Cayman Islands

MLS#: 413866

**US\$11,400,000**

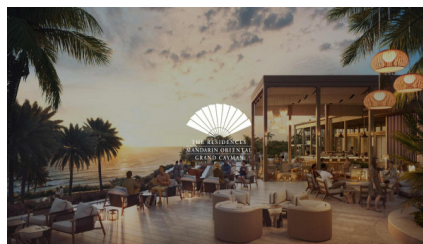
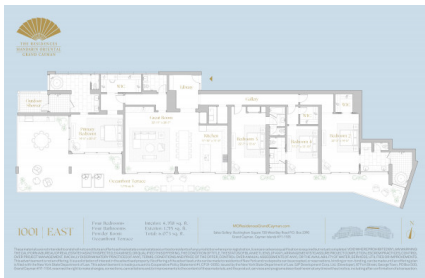



**James O'Brien**  
james@irg.ky

This magnificent one-of-a-kind 10th floor four-bedroom, four and one-half baths Residence is located on the west corner of the East tower. It spans 6,073 sqft, including 4,358 sqft of interior living area and 1,715 sqft of outdoor living area. Its library entry foyer accesses either the great room living, dining and kitchen areas as well as the art gallery accessing the three guest bedrooms, all of which, quite unusually, are ocean facing. Elevated ten-foot ceilings frame floor-to ceiling retractable glass opens onto the front and corner terraces. The open, gourmet kitchen features custom mill work cabinetry, Calacatta counter tops and back splashes with Wolf, Sub-Zero and Gaggenau appliances. The primary bedroom suite occupies the glassed corner between the oceanfront and corner terraces. It provides a 5-fixture bathroom featuring a windowed circular soaking tub with separate indoor and outdoor shower rooms. The second bedroom suite anchors the other end of the Residence also having a 5-fixture bathroom with a spacious windowed circular soaking tub and shower room. The third and fourth bedrooms enjoy ocean views and have en suite bathrooms. All bathrooms are appointed in a selection of natural stones including Travertine and Clef Cut Limestone. Seven-inch-wide Grey Oak flooring is hand-laid throughout the interior, seamlessly integrating with the Grey Wood Plank Porcelain tiling the outdoor terraces. The wrap-around corner terrace with grilling area offers sunrise and sunset views and outdoor dining and entertainment seating.

## Essential Information

Type	Status	MLS	Listing Type
<b>Residential (For Sale)</b>	<b>Withdrawn</b>	<b>413866</b>	<b>Condos</b>

## Key Details

Bed	Bath	Block & Parcel	Year Built
<b>4</b>	<b>4.5</b>	<b>32D,122UNIT1001</b>	<b>2024</b>

## Additional Fields

Views	Foundation	Stories/Condo	Floor Level
<b>Beach Front</b>	<b>Slab</b>	<b>1</b>	<b>10</b>
Construction	Class	Land Certificate	Possession
<b>Concrete</b>	<b>Under Construction</b>	<b>Issued</b>	<b>At Completion</b>
Sea Frontage	Porch	How Shown	
<b>700</b>	<b>Unscreened</b>	<b>By Appointment/List</b>	

## Property Features

City water  
**Yes**

Pool  
**Yes**

Tennis Courts  
**Yes**

Washer/Dryer  
**Yes**

Kitchen  
**Yes**

Family Room  
**Yes**

Dining Area  
**Yes**

Breakfast  
**Yes**

Utility  
**Yes**

Living Room  
**Yes**

Refrigerator  
**Yes**

Dishwasher  
**Yes**

Disposal  
**Yes**

Microwave  
**Yes**